



# *The Briarwood*

*By*

# *Blaze King*

**INSTALLATION &  
OPERATION MANUAL**

**HIGH QUALITY  
FREESTANDING  
NON-CATALYTIC  
WOODSTOVE**

**MODEL  
BR11/90**

**SOLID FUEL  
HEATER**

**RESIDENTIAL  
AND  
MOBILE HOME  
APPROVED**



LISTED BY:

Warnock Hersey



**READ THIS MANUAL PRIOR TO INSTALLATION OR OPERATION OF THIS APPLIANCE.  
PLEASE KEEP THESE INSTRUCTIONS FOR FUTURE REFERENCE.**

**MANUFACTURED BY BLAZE KING**

**IN CANADA  
VALLEY COMFORT SYSTEMS  
1290 COMMERCIAL WAY  
PENTICTON, BC  
V2A 3H5  
PHONE: (250) 493-7444  
FAX: (250) 493-5833**

**IN USA  
BLAZE KING INDUSTRIES  
146 A STREET  
WALLA WALLA, WA  
99362  
PHONE: (509) 522-2730  
FAX: (509) 522-9803**

---

## TO OUR VALUED CUSTOMERS

---

Dear Customer:

Thank you for purchasing the BRIARWOOD II, wood burning stove (hereafter referred to as "stove").

This owner's manual explains the steps required to safely assemble, install, operate, and maintain your new stove. Be a responsible stove owner; **PLEASE CAREFULLY READ THIS ENTIRE MANUAL BEFORE YOU INSTALL AND USE YOUR NEW STOVE. FAILURE TO FOLLOW THESE INSTRUCTIONS MAY RESULT IN PROPERTY DAMAGE, BODILY INJURY, OR EVEN DEATH.**

Obtain permits from the Building Inspector or Fire Department, if local laws require. Check local building and fire codes before installing your stove. When the installation has been completed by a qualified, licensed installer, have it checked by your local inspector. Disregarding inspection and code requirements may jeopardize your homeowner's insurance. Since some insurance carriers require notification of a stove installation, contact your insurance agent. We want your stove to give you many years of trouble-free operation.

While we have made every effort to make these instructions as complete as possible, some installation or operating conditions may not be covered. If you have any questions that are not answered here, contact your **BLAZE KING** dealer, Local Building Inspector, Fire Department, or our customer service department at Blaze King, Walla Walla, WA (509) 522-2730 (in Canada (250) 493-7444).

*Thank you for your purchase,*

The Management and Employees of

*Blaze King*

---

# TABLE OF CONTENTS

---

| <u>DESCRIPTION</u>                                     | <u>PAGE #</u> |
|--|---------------|
| GENERAL INFORMATION .....                              | 4-8           |
| WARRANTY .....   | 4             |
| APPROVAL LABEL .....                                   | 5             |
| SAFETY .....   | 6             |
| WARNINGS .....   | 6-7           |
| MAINTENANCE .....                                      | 8             |
| BAFFLE .....   | 8             |
| DOOR GASKET .....                                      | 8             |
| DOOR ADJUSTMENT .....                                  | 8             |
| ASHES .....  | 8             |
| FUEL .....   | 8             |
| CREOSOTE .....   | 8             |
| INSTALLATION .....                                     | 9-12          |
| LOCATION .....   | 9             |
| FLOOR PROTECTION .....                                 | 9             |
| CLEARANCES .....                                       | 9             |
| GENERAL INSTALLATION INSTRUCTIONS .....                | 10            |
| OPTIONAL COMPONENTS .....                              | 10            |
| CHIMNEY DRAFT .....                                    | 11            |
| CHIMNEY HEIGHT .....                                   | 11            |
| CHIMNEY REQUIREMENTS .....                             | 11            |
| CHIMNEY INSTALLATION—MASONRY CHIMNEY .....             | 12            |
| MOBILE HOME INSTALLATION INSTRUCTIONS .....            | 13            |
| GROUNDING .....  | 13            |
| CHIMNEY HEIGHT .....                                   | 13            |
| OUTSIDE AIR .....                                      | 13            |
| FLOOR PROTECTION .....                                 | 13            |
| ATTACHING STOVE TO FLOOR .....                         | 13            |
| OPERATION .....  | 14            |
| GRATES .....   | 14            |
| FIRST FIRE .....                                       | 14            |
| CURING PAINT .....                                     | 14            |
| STARTING FIRE .....                                    | 14            |
| CONTROLS .....   | 14            |
| DO NOT BURN .....                                      | 14            |
| HEAT OUTPUT .....                                      | 14            |
| DO NOT OVER FIRE .....                                 | 14            |
| ACCESSORIES—INSTALLATION—FAN KIT AND REAR SHIELD ..... | 15            |

**CAUTION: HOT WHILE IN OPERATION. DO NOT TOUCH. KEEP CHILDREN, CLOTHING AND FURNITURE AWAY. CONTACT MAY CAUSE SKIN BURN. READ NAMEPLATE AND INSTRUCTIONS BEFORE OPERATING THE HEATER.**

---

## GENERAL INFORMATION—WARRANTY

---

### BLAZE KING—*Briarwood*—LIMITED WOODSTOVE WARRANTY

**WARNING:** TO VALIDATE THIS WARRANTY YOU MUST COMPLETE AND RETURN THE ENCLOSED WARRANTY CARD WITHIN 20 DAYS OF THE DATE OF PURCHASE.

#### WHAT THE WARRANTY COVERS:

**Blaze King Industries and/or Valley Comfort Systems Inc. shall be referred to throughout this document as "Blaze King".**

This warranty contains different terms which cover different parts of the stove. Blaze King warrants the STEEL COMPONENTS of this stove, which is delivered with this warranty, against defects in material or workmanship to you, the original retail purchaser (hereafter referred to as purchaser), for a period of up to five (5) years following the date of original retail purchase, subject to the provisions of the RESPONSIBILITIES OF THE COMPANY below. Blaze King warrants the FAN ASSEMBLY, FRONT DOOR GASKET, and WOOD HANDLES of this stove, which is delivered with this warranty, against defects in material or workmanship, to the purchaser, for a period of one (1) year following the date of original retail purchase, subject to the provisions of the RESPONSIBILITIES OF THE COMPANY below. There is no warranty on paint, baffle plate, glass, gold plating or bricks. No person is authorized to modify this warranty or to make any additional warranties on behalf of Blaze King.

#### WHAT THE WARRANTY DOES NOT COVER:

Unless otherwise provided by law or covered by this warranty, Blaze King is not responsible for removal, transportation or re-installation of any product repaired or replaced pursuant to this warranty. Blaze King shall in no event be liable for special, incidental, consequential, indirect or other similar damages arising from the breach of the warranty, even if Blaze King has been advised of the possibility of such damages. Some states/provinces do not allow the exclusion or limitation of incidental or consequential damages, so the above limitation or exclusion may not apply to you. Blaze King limits all implied warranties, if any, including the warranties of merchantability or fitness for particular purpose, to one (1) year from the date of original retail purchase. Some states/provinces do not allow limitations on how long implied warranty lasts, so the above limitation may not apply to you. Actions for breach of this warranty must be brought within one (1) month of the expiration of this warranty. Blaze King is not responsible for installation and operational problems such as over-firing, use of improper fuel (corrosive driftwood, etc...), spillage or downdrafts caused by environmental conditions like trees, buildings, hilltops, mountains, or inadequate venting or ventilation, excessive offsets, negative air pressures caused by mechanical systems such as furnaces, fans, clothes dryers, etc.

#### HOW YOU CAN GET SERVICE:

If this product requires repair or replacement due to defects in material or workmanship covered by this warranty, contact your Blaze King dealer and explain the defect. If the dealer does not repair or replace the product to your satisfaction, contact the Service Department of Blaze King in the U.S.A. at 1-509-522-2730 and in Canada at 1-250-493-7444 or write to Blaze King at one of the addresses at the end of this warranty. Please explain the defect and state the model, serial number, date of retail purchase, and the name and address of your Blaze King dealer. Blaze King may request that the defective part, parts, or the entire stove, be shipped to one of Blaze King's manufacturing locations at the purchaser's expense.

#### WARNING:

Blaze King stoves have been thoroughly tested under extreme conditions, only abuse and over firing may create noticeable warping of components. Over firing of your stove will void all warranties implied or otherwise.

#### RESPONSIBILITIES OF THE COMPANY:

If the purchaser has complied with all of the terms and conditions of this warranty and if the purchaser has notified Blaze King of a defect prior to the expiration of the respective warranty period and after shipment, Blaze King will either repair or replace the product, AT ITS ELECTION, or MAY ELECT to refund a portion of the purchase price, based on the formula below, if it cannot readily and quickly provide the purchaser with a replacement. The repaired product or replacement will be shipped to a Blaze King dealer nearest the purchaser at Blaze King's expense. If it is determined by Blaze King that there is no defect, or that the defect resulted from causes not within the scope of this warranty, then the purchaser must bear the cost of storing the product and of returning the product to the purchaser. For parts of this woodstove or fireplace insert warranted beyond the first year, Blaze King will have the same obligations as described in this paragraph, provided, however, that the purchaser shall pay the following percentage of the then-current retail cost of the repair or the replacement, according to the year after purchase in which the defect is brought to the attention of Blaze King: during the 2nd year—purchaser pays 20%, during the 3rd year—purchaser pays 40%, during the 4th year—purchaser pays 60%, during the 5th year—purchaser pays 80%

This warranty is conditional upon the proper installation and use of the stove according to the manufacturer's directions embodied in the Owner's Installation and Operation Instructions published by Blaze King and in compliance with the local building or fire codes in the area where it is installed. The stove should be inspected by the Local Building Inspector or Fire Department prior to beginning use. A copy of the Owner's Installation and Operation Instructions is provided with each unit, or can be obtained by contacting Blaze King. READ THE OWNER'S INSTALLATION AND OPERATION INSTRUCTIONS BEFORE INSTALLING OR USING THE STOVE. SAVE THESE INSTRUCTIONS FOR FURTHER MAINTENANCE AND SAFETY PROCEDURES. Alteration of, abuse of, damage to, lack of maintenance of, faulty repair, OR misuse of the stove, VOIDS this warranty. Use of fuel other than natural untreated wood (such as artificial logs, wood exposed to salt water, or coal that may burn at excessively high temperatures or may release fumes that can explode) will VOID this warranty. Burning the stove with the loading door open (other than during the brief start-up period) will also VOID this warranty.

#### OTHER LEGAL RIGHTS OF THE PURCHASER:

This warranty gives you specific legal rights, and you may have other rights that vary from province to province or state to state. All parts of this warranty are to be interpreted in accordance with the laws of British Columbia/Canada and or Washington State/U.S.A.. If you do not agree to the terms and conditions set out in this warranty, then you must return the stove to the dealer prior to use or installation, and the purchase price will be refunded.

# GENERAL INFORMATION—APPROVAL LABEL

Warnock Hersey



## BRIARWOOD II/90 STOVE LISTED ROOM HEATER, SOLID FUEL TYPE Also for use in MOBILE HOMES

WH-

MODEL: BRII/90 Tested to : UL1482-1998 / ULC S627-M93 CERTIFIED IN BOTH UNITED STATES AND CANADA

**PREVENT HOUSE FIRES-** Install and use only in accordance with Blaze King's installation and operation instructions. Contact local building or fire officials about restrictions and installation inspection in your area.

**CHIMNEYS:** DO NOT CONNECT THIS UNIT TO A CHIMNEY FLUE SERVING ANOTHER APPLIANCE. Chimney must be a minimum of 6" listed factory built chimney suitable for use with solid fuels and conforming to, ULC629 in Canada or UL-103HT in the USA. If a non-listed chimney is to be used it must comply with all local and national codes, in Canada a non-listed chimney requires a full reline with a listed solid fuel chimney liner.

Mobile Home, residential close clearance, and residential alcove installations require 6" listed double wall close clearance chimney connector, with matching listed factory built chimney suitable for use with solid fuels and conforming to, ULC629 in Canada or UL-103HT in the USA.

Mobile Home installations are only allowed with a roof exit. Do not install in a sleeping room.

Alcove minimum width 55.5" / 1410 mm, minimum height from top of stove 36" / 914 mm, maximum depth 32" / 813 mm.

Passing through a wall or ceiling requires special methods: see local building codes.

**DO NOT PASS A CHIMNEY CONNECTOR THROUGH A COMBUSTIBLE WALL OR CEILING.**

Electrical rating: 115 VAC, 60 Hz, 0.58 Amps. Risk of electrical shock. Disconnect power before servicing unit. Do not route power cord in front of or beneath heater.

| Residential Installations   | A            | B            | C               | D            | E            |
|---|--------------|--------------|-----------------|--------------|--------------|
| Single Wall Pipe (24 MSG Black)   | 15" / 381 mm | 15" / 381 mm | 25.75" / 654 mm | 18" / 457 mm | 15" / 381 mm |
| Listed Double Wall Pipe—Close Clearances<br>Use side shields and rear shield.<br>(Must use for Mobile / Manufactured Home Installations, Alcove Installation and Close Clearance Installations) | 14" / 356 mm | 8" / 203 mm  | 24.75" / 629 mm | 11" / 279 mm | 8" / 203 mm  |

**MINIMUM CLEARANCES TO COMBUSTIBLES** (See owners manual for complete description of all requirements)

**\*\* Mobile Home and Alcove Installations must use double wall listed pipe, side shields and rear shield. Mobile Home Installations require Outside Combustion Air Kit # Z1526.**

Floor protection may be any non-combustible material or Listed Floor Protector, and must extend at least 18" / 406 mm in front of the loading door opening. Minimum size is 44x 36" .

**U.S. ENVIRONMENTAL PROTECTION AGENCY-** Certified to comply with July, 1990 particulate emission standards.

\*Operate with doors closed. Open door to feed fire ONLY. Do not obstruct combustion air openings. Provide adequate outside air for combustion. \* Use only high temperature ceramic glass if replacement is necessary, 5 mm. thickness

**KEEP FURNISHINGS AND OTHER COMBUSTIBLE MATERIALS WELL AWAY FROM HEATER. DO NOT OVERFIRE! IF HEATER OR CHIMNEY GLOWS YOU ARE OVERFIRING.**

For use with solid fuel only. Use of other fuels may cause a house fire or endanger your safety.

Refer to Installation and Operations manual for installation and operation instructions.

**CAUTION:** HOT WHILE IN OPERATION. DO NOT TOUCH. KEEP CHILDREN, CLOTHING AND FURNITURE AWAY. CONTACT MAY CAUSE SKIN BURN. READ THIS LABEL AND INSTRUCTION MANUAL BEFORE OPERATION OF STOVE.

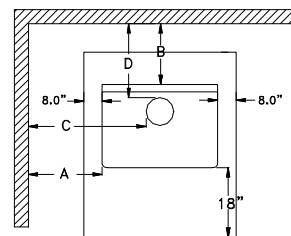
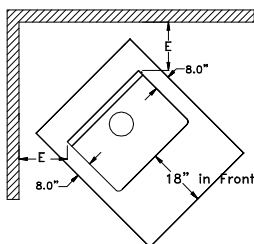
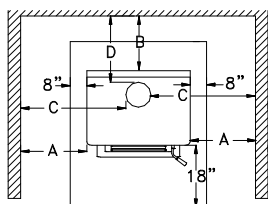

**MANUFACTURED IN:**

USA:  
Blaze King Industries  
146A Street  
Walla Walla, WA.  
99362

Canada:  
Valley Comfort Systems  
1290 Commercial Way  
Penticton, B.C.  
V2A 3H5

**MANUFACTURE DATE**

JAN  FEB  MAR  APR  MAY  JUN   
 JUL  AUG  SEP  OCT  NOV  DEC   
 2001  2002  2003  2004  2005  2006

0164 Rev 08/2001

---

## **GENERAL INFORMATION—SAFETY**

---

### **BRIARWOOD FREE STANDING ROOM HEATER Model BR11/90 Residential and Mobile Home Approved**

Briarwood Room Heaters have been developed, tested and constructed in accordance with the requirements of UL 1482-1998 / ULC S627-M93. Safety testing was performed by Intertek Testing Services laboratories. These units are designed as safe and efficient, solid fuel burning heaters, but they must be properly installed and operated. This manual describes the installation and operation of your new stove; carefully read and follow all of the requirements and instructions included.

This heater meets the U.S. Environmental Protection Agency's emission limits for non-catalytic wood heaters built on or after July 1, 1990. Under specific test conditions this heater has been shown to deliver heat at rates ranging from 10,600 - 36,000 BTU/Hr.

We strongly recommend that you hire a licensed installer to properly install your Briarwood stove. In the USA technicians are certified by the HPA, in Canada technicians are certified by WETT.

Contact your local building inspector before your installation begins to ensure that you comply with all local building and fire codes. Have your installation safety inspected before you put your stove into operation.

#### **SAFETY NOTICE:**

**IF THIS HEATER IS NOT PROPERLY INSTALLED, A HOUSE FIRE MAY RESULT. FOR YOUR SAFETY, FOLLOW THE INSTALLATION INSTRUCTIONS. CONTACT LOCAL BUILDING OR FIRE OFFICIALS ABOUT RESTRICTIONS AND INSTALLATION REQUIREMENTS IN YOUR AREA.**

#### **WARNING!**

**MOST HOME FIRES CAUSED BY WOODBURNING STOVES ARE THE RESULT OF IMPROPER  
INSTALLATION AND OPERATION.**

**READ ALL INSTRUCTIONS THOROUGHLY BEFORE INSTALLING AND OPERATING YOUR  
Briarwood II STOVE.**

**SAVE THESE INSTRUCTIONS.**

#### **SAFETY PRECAUTIONS:**

- 1. CONSULT YOUR LOCAL BUILDING INSPECTOR TO ENSURE COMPLIANCE WITH BUILDING AND FIRE CODES.**
2. Design your installation with safety as the primary consideration.
3. Finish the installation completely before putting your stove into operation.
4. Use only prescribed material for your installation.
- 5. WARNING: FOR USE IN MOBILE HOMES, DO NOT INSTALL IN SLEEPING ROOM OR BEDROOM.**
6. Use floor protection which meets the minimum measurements and clearances as shown on page 9 (must be installed with the heater).
7. The Briarwood stove is designed for burning wood only.
8. Create a safety zone around the stove where children may not enter. carefully supervise youngsters when they are in the same room with the stove.
9. The stove will be hot when burning properly, and will set objects such as clothing and curtains, on fire if they touch it. Keep furnishings and any other combustibles away from the heater.

**WARNING: BE ABSOLUTELY SURE THAT THE DISTANCE BETWEEN THE HEATER AND ANY COMBUSTIBLE MATERIAL IS NOT LESS THAN THAT SHOWN ON THE APPROVAL LABEL.**

10. Be sure everyone is aware of high surface temperatures and avoid contact with skin or clothing and combustible items to avoid ignition.
11. Do not dry clothing on or near the stove.
12. Do not let anyone operate the stove who is not familiar with its operation. .
- 13. NEVER USE CHEMICALS, GASOLINE, GASOLINE TYPE LANTERN FUEL, KEROSENE, CHARCOAL LIGHTER FLUID OR SIMILAR LIQUIDS TO START OR "FRESHEN UP" A FIRE IN THIS HEATER. KEEP ALL SUCH LIQUIDS WELL AWAY FROM THE HEATER WHILE IT IS IN USE.**

---

## GENERAL INFORMATION—SAFETY

---

14. Provide for fresh air inlet into the room while the stove is in operation or install the outside combustion air kit designed for this unit.
15. Do not leave the house unattended for long periods of time when the stove is in operation.
16. Make sure pipe connections cannot accidentally come apart. Use sheet metal screws to secure pipe connections.
17. Clean your chimney and associated components regularly. Do not allow excessive build-up of ashes in the stove, or allow ashes to spill from the stove when the door is opened.
18. Check masonry chimneys for cracks which may allow back-puffing and fumes to re-enter the house. Inspect for excessive creosote build-up frequently.
19. Have your stove installation safety inspected before you build a fire in it the first time.
20. If you cook on your stove top, have a proper fire extinguisher close at hand to extinguish grease fires. Never use water to control a grease fire. Also be careful to keep handles on pots and pans from extending beyond the stove where they may be accidentally knocked over.
21. Install a smoke detection alarm system, and a CO (carbon monoxide) detector in your home. Smoke detectors should not be installed in front of stove as small spills of smoke may set them off.
22. Every home should have a fire extinguisher. Consult local fire officials or authorized fire extinguisher company for proper equipment.
23. For further information on using your heater safely, obtain a copy of the National Fire Protection Association publication, "Using Coal and Wood stoves Safely", NFPA Number HS-6-1974. The address of the NFPA is: 470 Atlantic Avenue, Boston, MA 02210.
24. For further information, refer to NFPA 211.
25. Do not over fire your woodstove. Although the Briarwood II is designed to heat efficiently, it should never be fired to a red-hot condition.
- 26. CHIMNEY CONNECTOR MAY NOT PASS THROUGH AN ATTIC OR ROOF SPACE, CLOSET OR SIMILAR CONCEALED SPACE, OR A FLOOR, CEILING, WALL, OR PARTITION OF COMBUSTIBLE CONSTRUCTION.**
27. This heating appliance is not to be connected to any "Air Distribution Duct".
28. Do not store firewood, kindling or any other combustible materials within the clearances on this stove. See page 9 or the label on the stove for clearance information.
29. This stove must not be operated with the loading door open, other than to load fuel. Operating this stove with the loading door open could cause a house fire or personal injury.
30. Do not abuse, strike or slam the loading door, as the glass may break and will not be covered under warranty.
31. This stove shall not be operated with cracked or broken glass.
32. Do not clean glass while it is hot. Do not clean glass with abrasive cleaners.
33. If replacement parts are required, substitute materials are prohibited and will void your warranty.
34. Do not use fuels in this stove other than solid wood. Use of other fuels such as coal, charcoal or others, will void your warranty and may cause damage to the stove, a house fire or personal injury.
- 35. SAVE THESE INSTRUCTIONS.**

**THE INFORMATION CONTAINED HEREIN IS BELIEVED TO BE ACCURATE. HOWEVER, NO RESPONSIBILITY FOR ERRORS OR OMMISIONS IS ASSUMED BY BLAZE KING INC.**

---

## GENERAL INFORMATION—MAINTENANCE

---

### REMOVABLE BAFFLE PLATE

The baffle is the part of the stove which receives the most heat. For this reason, as well as for chimney cleaning ease, it has been made to be easily removed. Remove the screws on each side of baffle, and this will allow the baffle to slide forward and out. The baffle plate may be damaged by over firing and burning improper fuels. Baffle plate damage is not covered by warranty. To order replacement baffles please call your dealer with the model and serial number of your stove.

### GASKET REPLACEMENT

Door gasket: Inspect gaskets frequently for leakage and deterioration. To replace damaged gasket, first remove old gasket and clean channel thoroughly. Apply stove gasket adhesive in channel and press the **7/8" dense fiberglass rope gasket** into channel, (begin and end in lower right corner ensuring a tight fit where the two ends join). Close door tightly and fire the stove to set the seal. The door latch is adjustable if necessary. Visually inspect periodically, throughout the heating season to ensure an airtight seal.

### GLASS REPLACEMENT

Do not slam the loading door or otherwise impact the glass. If the glass gets cracked or broken, it must be replaced before using the stove. Replacement parts can be obtained from your authorized Blaze King dealer. The glass is a 5mm high temperature ceramic, substitute materials are not permitted. As a general rule, whenever you replace the glass on your stove, your gaskets should be replaced as well. To replace the glass let your stove cool down, never handle a hot door or hot glass. After the door and glass is cool to touch, remove the door from the stove. Remove the door gasket, glass retainer and gasket and the old glass. Use caution when handling broken glass, it can be very sharp. Install the new glass complete with gasket in your door. Please ensure that the glass retainer is properly secured to the door to provide a good seal. Do not over-tighten the screws, this can damage the glass. To learn more about replacing your door gasket, read the above section on gasket replacement.

### ASHES

Your stove works best when you consistently maintain a good bed of coals, although ash build-up does need to be cleaned out periodically. Remember that a wood fire does burn best with about a half inch of ashes.

**Disposal of ashes:** Ashes should be placed in a metal container with a tight fitting lid. The closed container of ashes should be placed on a non-combustible material pending final disposal. If the ashes are disposed of by burial in soil or otherwise locally disposed, they should first be retained in the closed container until all cinders have thoroughly cooled.

### WET OR GREEN FUEL

Wet or green fuel should not be used. Wood should be cut into pieces and allowed to air dry for several months before attempting to burn it. After the wood supply is cured (dry), ensure it is protected from rain and snow so that moisture is not absorbed. However, if you do add wet or green fuel to an existing fire, open the draft control to intensify the fire and burn off moisture. When completed return the draft control to desired operating position. You will not get much heat output from your stove while burning green or wet fuel, a large amount of the energy produced by the fire is used to evaporate the moisture from the fuel load, this energy is wasted and will not come into your home. **REMEMBER, WET OR GREEN FUEL CAUSES INCREASED CREOSOTE FORMATION.**

### CREOSOTE - Formation and Need for Removal

When wood is burned slowly, it produces tar and other organic vapors, which combine with expelled moisture to form creosote. The creosote vapors condense in the relatively cool chimney flue of a slow burning fire. As a result, creosote residue accumulates on the flue lining. When ignited this creosote makes an extremely hot fire.

The chimney connector and chimney should be inspected at least once every two months during the heating season to determine if a creosote buildup has occurred.

If creosote has accumulated it should be removed to reduce the risk of a chimney fire.

Creosote build-up may be minimized by using dry, seasoned wood, especially hardwoods. Avoid burning green wood at any time, but especially during periods of slow burning such as overnight. Recommended burning practices also reduce creosote build-up. It has been found that opening the draft controls to allow the fire to burn freely for 3- 4 hours in your stove each week will cut down on creosote build-up. Open the draft controls each time fuel is added and allow the fire to flame a few minutes before closing the draft controls again. After an overnight burn, open the draft controls and allow the fire to flame hot for five or ten minutes with dry kindling.

Remember, these practices are to reduce creosote build-up. If creosote has built up already, have the chimney cleaned immediately. If a creosote fire should develop lose the air intake, call the fire department immediately, and ensure that all persons are out of the house and safe. After a severe chimney fire, the complete chimney system and connecting pipes must be checked by a qualified person before further use.

# INSTALLATION—LOCATION & CLEARANCES

## YOUR STOVE'S LOCATION

1. Your stove should be centrally located in the area to be heated. It should be placed away from doors and hallways and out of the line of traffic as much as possible. Plan ahead to be certain that furniture will have ample clearance, and the drapes and curtains cannot come within the combustible clearances listed on the table below.
2. This stove must be connected to a chimney. It must be vented to the outside. Never permit your stove to ventilate itself into any room in the building.
3. Check the attic or space above the ceiling or behind walls through which you intend to run your stove pipe and chimney to assure there are no existing heating ducts, electrical wiring, conduit, or major structural support beams in the way. A straight stove pipe is best.
4. Consult illustrations in the back of this manual to ensure that you install your stove the proper minimum distances from combustible materials.

## FLOOR PROTECTION

Floor protection may be any non-combustible material or Listed Floor Protector. It must extend at least 18" in front of the loading door opening and 8 inches beyond the sides of the door opening in USA, or 8 inches beyond the side of the stove in Canada and inline with the rear of the stove. In certain installations floor protection must be provided under the chimney connector and 2 inches beyond each side of the chimney connector. Position the floor protector so that no floor ducts are covered.

## CLEARANCES TO COMBUSTIBLE MATERIALS

| Residential Installations   | A            | B            | C               | D            | E            |
|---|--------------|--------------|-----------------|--------------|--------------|
| Single Wall Pipe (24 MSG Black)   | 15" / 381 mm | 15" / 381 mm | 25.75" / 654 mm | 18" / 457 mm | 15" / 381 mm |
| Listed Double Wall Pipe—Close Clearances<br>Use side shields and rear shield.<br>(Must use for Mobile / Manufactured Home Installations, Alcove Installation and Close Clearance Installations) | 14" / 356 mm | 8" / 203 mm  | 24.75" / 629 mm | 11" / 279 mm | 8" / 203 mm  |

**\*\* Mobile Home and Alcove Installations must use double wall listed pipe, side shields and rear shield.  
Mobile Home Installations require Outside Combustion Air Kit # Z1526.**

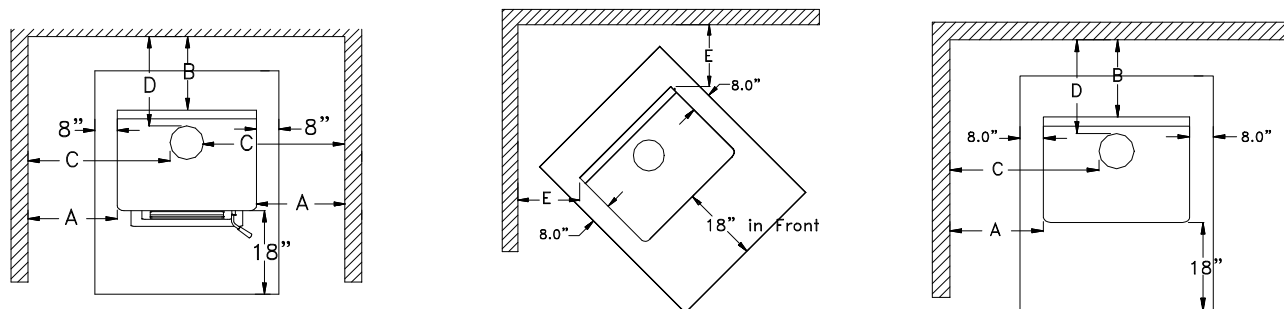

# INSTALLATION—GENERAL

## BRIARWOOD II FREE STANDING STOVE INSTALLATION PROCEDURE

**Note:** This is a generic installation procedure. Always follow your chimney manufacturers installation instructions accurately. Make sure that all local codes are met and have your installation inspected prior to stove operation.

*For Mobile Home Installation, refer to the mobile home sections before proceeding.*

**AFTER YOU READ AND FULLY UNDERSTAND THE MATERIAL IN THIS MANUAL, YOU ARE READY TO PROCEED WITH THE INSTALLATION OF YOUR STOVE.**

**SAFETY NOTICE: IF THIS HEATER IS NOT PROPERLY INSTALLED, A HOUSE FIRE MAY RESULT. FOR YOUR SAFETY, FOLLOW THE INSTALLATION DIRECTIONS. CONTACT LOCAL BUILDING OR FIRE OFFICIALS ABOUT RESTRICTIONS AND INSTALLATION REQUIREMENTS IN YOUR AREA.**

1. Select the exact place where you want to permanently install your stove. Set the unit in place. Check for clearances from combustible walls and materials for your particular model. Refer to page 9 (Location and Clearances). Plan ahead so the other movable combustibles, such as furniture and drapes, will have ample clearance from your stove. Before cutting through walls and ceilings, check to be sure there are no ducts, conduit, electrical wires, or vital structural support beams and rafters in the way of your stovepipe and chimney.
2. If a hole is to be cut through the ceiling, use a plumb bob to locate the hole in the ceiling by aligning the plumb bob with the exact center of the flue on your stove.
3. If you are installing a new chimney, follow the manufacturer's installation instructions very carefully. Be sure to comply with all safety recommendations. Use only insulated pipe and components with approved shields to pass through combustible walls and ceilings.
4. Make a mark on the floor around each corner of the heater. Move the stove and install the floor protector. Be sure to extend the stove board beyond the stove as outlined on page 9 (Location and Clearances).
5. Place stove on properly sized floor protection in exact location and install chimney connector.
6. After properly installing chimney connector, run the stovepipe from the connector to the flue on the stove. Use three sheets metal screws evenly spaced around the pipe on each joint, including the flue collar. Seal joints with stove cement.
7. Make certain proper minimum distances have been maintained between combustible surfaces and both the stove and stovepipe.

## BRIARWOOD II OPTIONAL COMPONENTS

Your Briarwood Residential and Mobile Home Stove is listed for use with the following components:

Z1514 Blower Unit, Z1526 Outside Combustion Air Kit, Z1234 Rear Heat Shield Kit, Z1539 Mobile Home Anchor and Grounding, Z5678 Gold Door Trim Kit, and S/SBR1190 Side Heat Shields (Rear shield or Fan Kit Required).

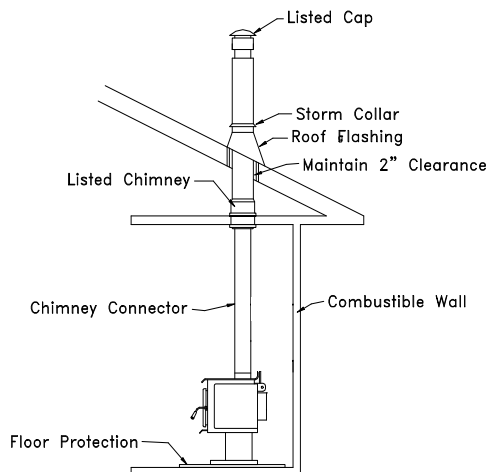

Typical Installation: Metal Prefabricated Chimney Through Roof

For close clearance installations use listed double wall chimney connector for your chimney system. Also required for close clearance installation are the side shield kit and rear shield kit.

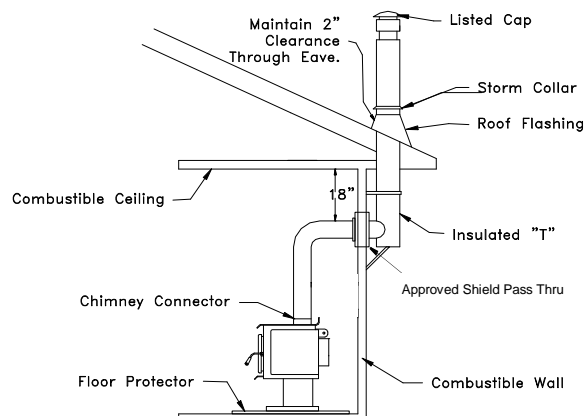

Typical Installation: Metal Prefabricated Chimney Through Wall

---

# INSTALLATION—CHIMNEY GENERAL

---

## CHIMNEY DRAFT

Draft is the force which moves air from the appliance up the chimney and pulls fresh, oxygen-rich air into the combustion chamber. Your stove can not force smoke up the chimney but rather your chimney must always "suck" the smoke out of your stove. The smoke will always try to go to the area of lowest pressure. The amount of draft in your chimney depends on the length of the chimney, local geography, nearby obstructions, and other factors. Too much draft can cause excessive temperatures in the appliance and may damage the unit.

Inadequate drafting may cause back puffing into the room and plugging of the chimney. Inadequate draft may also cause the appliance to leak smoke into the room through the appliance and chimney connector joints.

An uncontrollable burn or glowing red stove part or chimney connector indicates excessive draft. Unit failure to "get hot", or "burn hot", or if you experience poor burn times, can be the result of inadequate chimney draft or excessive chimney draft. In most instances if the stove is vented into an exterior masonry chimney and the draft is inadequate you will need to line the outside chimney with a stainless steel liner.

Excessive draft can create over firing, short burn times and damage to internal components.

## CHIMNEYS

**In Canada:** Any 6" ULC-S629 listed chimney system installed according to the manufacturers instructions.

**In U.S.A.:** Any 6" UL-103HT listed chimney system installed according to the manufacturers instructions.

**Masonry Chimney:** Masonry Chimney's must be constructed to local codes. Inspection and approval by local code authorities is required. Listed stainless steel chimney liners and connectors are highly recommended in masonry chimney installations. Listed solid fuel chimney liners are required for masonry installations in Canada.

Mobile home units require certain listed components and chimney manufacturers. See Mobile Home Instructions (page 12) for details.

Refer to the chimney and chimney connector manufacturer's instructions for additional information. If this stove and its chimney components are not properly installed, a house fire may result. For your safety, follow the installation directions. Contact local building or fire officials about restrictions and installation requirements in your area.

Your chimney should be at least the same dimension (inside diameter) as the flue of your stove. If you plan to use an existing masonry chimney, be sure it is free of cracks and loose joints. Gases traveling through a chimney reach extremely high temperatures. Cracks or loose mortar can allow hot gases to reach the wood portion of the structure surrounding the chimney. These toxic gases may also re-enter the house through cracks and small holes in the chimney, or cause back-puffing which will result in excessive smoking. Be on the safe side and have your chimney inspected by a certified chimney sweep. A 6 inch stainless steel chimney liner with a direct connection to the stove is recommended for Masonry chimney installations. Outside masonry chimney's almost always require a listed liner system to ensure proper draft.

A chimney must reach at least three feet above the highest point where it passes through the roof and at least two feet higher than any portion of the building within ten feet of the chimney. Smoke travels up the chimney in a circular, spiraling motion. A 6 inch round stainless steel liner allows the smoke to travel with less resistance. A rough masonry chimney without a good smooth liner will allow creosote to build up quickly.

**Check all local codes and regulations regarding your installation before you begin.**

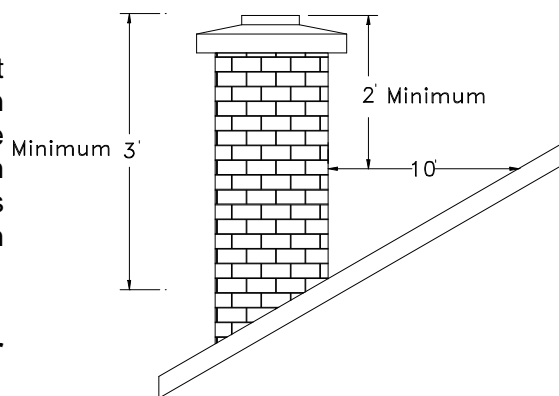

**\*\*\* DO NOT CONNECT THIS UNIT TO A CHIMNEY FLUE SERVING ANOTHER APPLIANCE. \*\*\***

# INSTALLATION—MASONRY CHIMNEY AND CONNECTOR

**Note:** This is a generic installation procedure. Always follow your chimney manufacturers installation instructions accurately. Make sure that all local codes are met and have your installation inspected prior to stove operation.

## Wall Exit—Masonry Chimney

1. Set floor protector and stove in location for marking holes in accordance with the label and figures of these instructions (see page 9).
2. Mark position for the hole in the wall or masonry chimney.
3. Move the stove out of the way.
4. Cut the pilot hole in the wall and/or masonry chimney.
5. Cut the hole for the wall penetration components and frame in the sides of this hole. Install Listed Wall Pass-Through. Refer to the pipe manufacturer's installation instructions.
6. Follow the manufacturer's installation instructions to install Prefabricated Chimney system. **NOTE:** to meet the code, the chimney must extend above the roof at least three feet and two feet above any area of the roof within ten feet of the termination of the chimney. The stove's flue collar accepts only 6" chimney connector. The small end of the connector fits into the collar to enable any water vapor which may form in the chimney to drain back into the stove. Close clearance chimney connector is not normally required for residential standard clearance installations. Check with your local building or fire inspector for local requirements. Chimney connectors can also be used horizontally as a connection between the stove and a masonry chimney, provided that the horizontal length does not exceed three feet **AND THE CONNECTOR SLOPES UPWARD TOWARD THE CHIMNEY AT THE RATE OF 1/4" PER FOOT.** This slope in the horizontal connection is required to encourage the water vapor to drain back into the stove. Use a carpenter's level and a ruler or tape measure to check the slope. You should also use a level to check the chimney connector exiting the stove to be sure it is vertical. Under no condition should the chimney connector have more than one 90 degree bend or two 45 degree bends. The distance between the chimney connector and the ceiling must not be less than 18". The chimney connector sections should be attached to the stove's flue collar with screws per joint. The chimney connector should be attached to the stove's flue collar with screws provided. Be sure all options including outside air cap, flange, collar and pipe are installed at this point before putting the stove in its final position.
7. Slide the stove back into position.
8. To install the Chimney Connector, slip the lower (crimped) edge of the pipe inside the smoke collar. Install the remaining lengths of pipe, one on top of the other, to the finished height of the Chimney Connector, and secure to each other.

**Note: Canadian Installations into masonry chimneys must be fully re-lined with a listed solid fuel chimney liner. Proper listed chimney liners are recommended for all masonry installations.**

For close clearance installations use listed double wall chimney connector for your chimney system. Also required for close clearance installation are the side shield kit and rear shield kit.

6" Diam. 24/26 MSG. Black/Blue Steel Chimney Connector with listed residential type and building heating appliance chimney system.

Combustible Wall

Attach chimney connector to collar with screws provided

Floor Protector

**FIGURE**

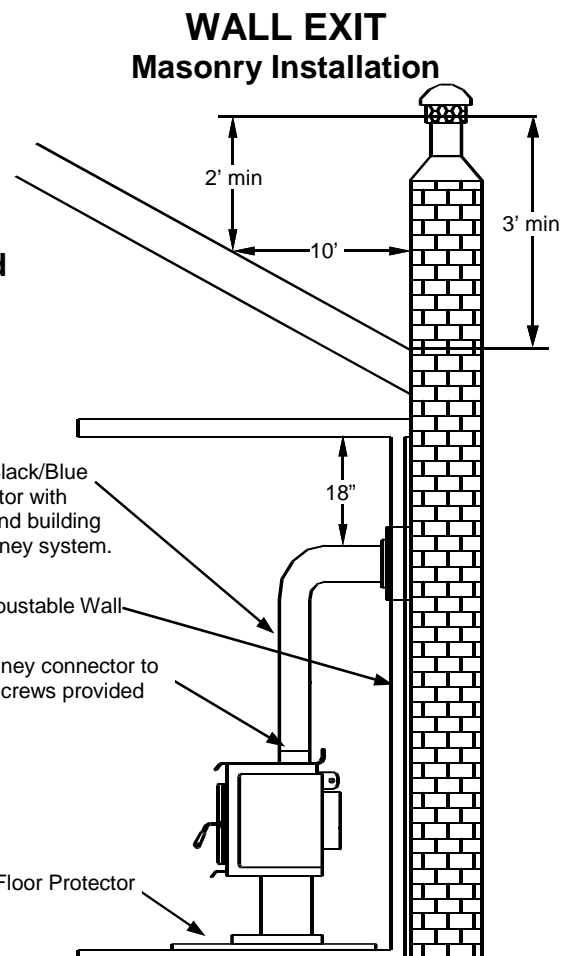

---

# INSTALLATION—MOBILE HOME

---

## MOBILE HOME INSTALLATION

**WARNING: DO NOT INSTALL IN SLEEPING ROOM OR BEDROOM.**

**CAUTION: The structural integrity of the mobile home floor, wall, and ceiling/roof must be maintained.** Mobile Home Installation requires certain methods and components not necessary for Residential Installation to conform to UL and/or standards and applicable building codes. Briarwood II Stoves have been tested and listed for these requirements with the use of the correct components and methods, herein described. Starvation of air can cause smoke spillage into your home, which can be harmful to your health. Make sure that there is adequate ventilation.

### The additional requirements are:

1. Mobile Home upgrade requires parts
2. **In Canada:** Any 6" ULC-629 listed chimney system with the accompanying double wall vent connector.
3. **In U.S.A.:** Any 6"HT-103 listed chimney system with the accompanying double wall vent connector.
4. Do not connect a listed chimney of one manufacture with a listed double wall connector from another manufacture.
5. Outside Combustion Air is required on all mobile home stoves.
6. Spark arrestor type chimney caps are required on mobile home stoves and must be secured to the chimney.
7. The stove must be anchored or secured to the floor of the mobile home.
8. The chimney must pass at least 3 feet above the part of the roof through which it passes.
9. To provide adequate combustion air, ducting is required directly from the outside to the connection point of the stove or under the pedestal.
10. Grounding of this unit is required. The anchoring and grounding kit provide means to attach the ground wire.
11. Installation requirements for mobile homes are in addition to residential requirements.

## GROUNDING

Whether or not the stove uses a blower it must be electrically grounded to the frame of the mobile home with a number eight copper conductor. Attach the grounding wire to one of the screws on the rear of the base of the stove. Always use a star lock washer to ensure a good electrical connection between the ground wire and the stove.

## CHIMNEY HEIGHT

The chimney system must provide for a section joint so that any parts extending over 13 feet, 6 inches above ground level can be removed for transportation of the mobile structure. Care must be taken in disassembly so no hidden joints are loosened to allow flue emissions to enter the mobile structure when reassembled and placed in operation.

## OUTSIDE COMBUSTION AIR

Make sure the space above and below the stove will permit penetration of the stove chimney and floor duct. The floor duct for mobile homes can be used for residential installations. Note where the air inlet at the base of the stove will be. Then, mark on the floor the exact location where the floor duct will penetrate. cut a 6 inch diameter opening in the floor. Using the screws provided, install the floor duct.

**CAUTION: The air duct must not destroy the integrity of the space through which it passes AND MUST ALWAYS REMAIN OPEN. In locations where snow might cut off the air supply, a provision must be added to prevent such an occurrence, such as continuing the floor duct to a height above the snow level.**

## FLOOR PROTECTOR

Now, install the floor protector. Floor protection may be any non-combustible material or Listed Floor Protector. It must extend at least 18" in front of the loading door opening and 8 inches beyond the sides of the door opening, or 5 inches beyond the side of the stove top and inline with the rear of the stove. Position the floor protector so that no heating ducts are covered. Make sure the hole in the floor protector matches the hole in the floor. NOTE: Reseal any area of the vapor barrier that has been penetrated. (Also see Page 9)

## ATTACHING STOVE TO FLOOR

Position the stove on the floor protector so that the minimum clearances are met. Drill down through the holes in the base of the stove, penetrating both the floor protector and the floor of the home. Then, place two lag screws through the holes and fasten them securely to the floor of the structure. Make sure the stove cannot shift or move.

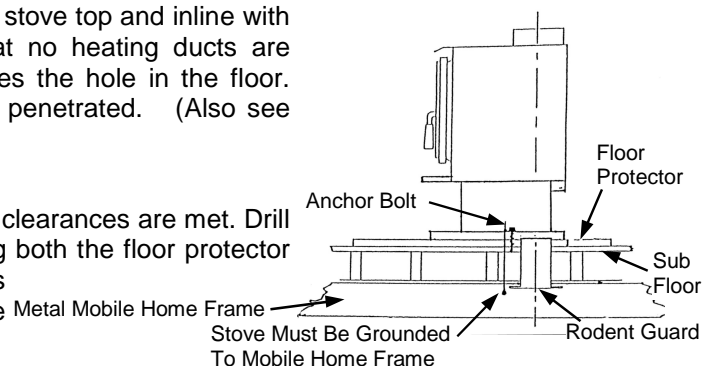

---

## OPERATION—GENERAL

---

### GRATES OR ANDIRONS

Briarwood Stoves are designed for the burning of wood directly on the firebrick. Best efficiency and burn characteristics are obtained when a half inch bed of ashes is maintained in the firebox.

### STARTING YOUR FIRST FIRE (*Curing Your Stove Paint*)

Make sure you provide extra ventilation by opening a door or window as the paint will give off fumes while it is curing. There will also be some paint odor during your first few fires. To cure the paint on your stove you should build a small kindling fire, let it die down; build another fire, slightly larger, let it die down; build yet another fire, slightly larger (stove should be fairly hot by this point). Do not over fire your woodstove for the next few fires - this should sufficiently cure the paint. If you should have any blistering or peeling of paint, it can be sanded down and repainted with high temperature stove paint, available in aerosol cans from your local dealer. **NOTE: The paint is not covered by the warranty.**

### STARTING A FIRE

"DO NOT TAMPER". It is against the law to alter this wood heater. This heater is designed for clean burning in accordance with rules and regulations of the U.S. Environmental Protection Agency. "It is against the law to operate this wood heater in a manner inconsistent with operating instructions in this manual."

**CAUTION: NEVER USE GASOLINE, LANTERN FUEL OR KEROSENE, CHARCOAL LIGHTER FLUID OR SIMILAR LIQUIDS TO START OR FRESHEN UP A FIRE IN THIS HEATER. KEEP ALL FLAMMABLE LIQUIDS A SAFE DISTANCE FROM YOUR STOVE.**

1. Place several pieces of "wadded up" or "balled" paper in the firebox.
2. Place several pieces of small, dry, finely split kindling on the paper.
3. Light the paper in several places and hold the door partially open (usually 2-3 inches) until the kindling is ignited adequately to sustain combustion with the door closed.
4. Make sure the draft control is on the high setting. See illustration below.
5. Allow the fire to burn until an adequate bed of coals is formed.
6. You may now place several larger pieces of wood on the fire. In order to insure complete combustion of the organic compounds released from the wood, load the fuel as far back in the firebox as possible. Also, the charcoal bed can be sloped slightly towards the rear so that the fuel does not tend to fall forward. Again, close the door with the draft control open until a robust fire occurs.
7. Clean any coals away from the front of the starter manifold which may create an obstruction of starter air to the fuel. Operate on high setting for at least 5 minutes or until combustion will sustain at starter manifold before closing draft to desired setting. After refueling operate with blower "off" for at least 30 minutes.

### CONTROLS

This stove is equipped with a combustion air control (draft control) located beneath the door opening. This control regulates the heat output and burn time of the stove. Closing the setting restricts the incoming combustion air for minimum heat output and maximum burn duration. The further open the setting, the faster the fuel will burn and the higher the heat output.

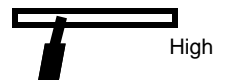

**Draft Control**

This heater is designed to burn natural cord wood only. Higher efficiencies and lower emissions generally result when burning air dried seasoned hardwoods, as compared to softwoods or too green or freshly cut hardwoods.

### DO NOT BURN

Do not burn treated wood, solvents, coal, colored paper, garbage, trash, cardboard, board ends, plywood, composite boards, etc...

**CAUTION: Do not burn board ends, kiln dried lumber, etc. for other than kindling purposes. Extended use may damage the stove and void warranties.**

### HEAT OUTPUT

The heat output of this stove depends on the amount of wood used, the type and dryness of wood used, the size of smoke path leading from the woodstove and the amount of air entering the woodstove.

### DO NOT OVER FIRE YOUR HEATER

Although your woodstove has been designed to heat efficiently and operate at high temperatures, it is meant to supplement other heating means in your home, and it should never be fired to a red hot condition. Once the woodstove is in use, it should be checked frequently to be sure that it is operating at the temperature range you have selected.

---

## ACCESSORIES—FAN KIT & REAR SHIELD

---

### Accessory Installation Instructions—Fan Kit (#Z1514) And Rear Shield (#Z1234)

- A- Place rear heat shield on the stove so that the notch on the shield is over the lip on the stove top
- B- Attach the rear heat shield with 4 bolts through the shield and into the back of the stove.
- C- Position the fan kit on the rear heat shield, the mounting holes are pre punched and located near the bottom. Attach using four #10 sheet metal screws.

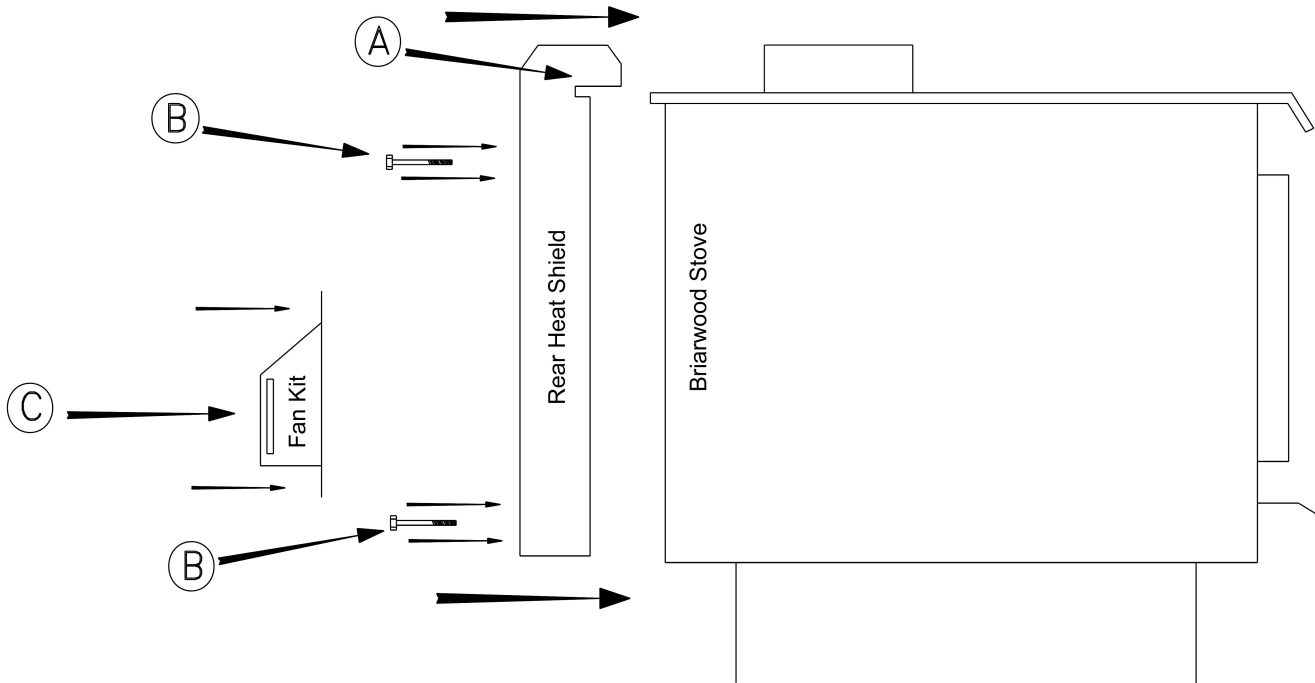

**\*\* USE CARE WHEN ROUTING THE POWER CORD, MAKE SURE IT IS NOT UNDERNEATH THE BASE OF THE STOVE. \*\***

### Fan Kit Electrical Diagram

