

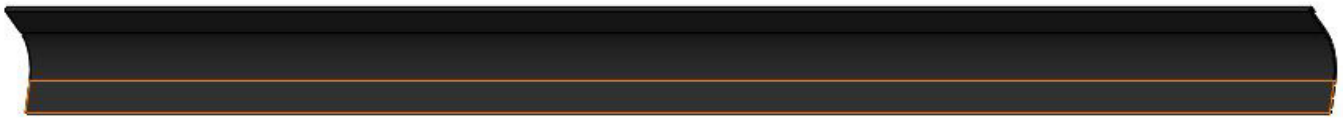

**S.Z4991 CL2714 MANTEL SHIELD 40”**

**S.Z4992 CL2714 MANTEL SHIELD 32”**



**CALIFORNIA PROPOSITION 65**

**WARNING:** This product can expose you to chemicals including benzene, which is known to the State of California to cause cancer and birth defects or other reproductive harm. For more information:

**[www.P65Warnings.ca.gov](http://www.P65Warnings.ca.gov)**

**Manufactured By**

**Valley Comfort Systems Inc.**

1290 Commercial Way  
Penticton, BC V2A 3H5  
CANADA

Phone: 250-493-7444  
Fax: 250-493-5833

**Blaze King Industries**

146 A Street  
Walla Walla, WA 99362  
U.S.A.

Phone: (509) 522-2730  
Fax: (509) 522-9803

Pour la version française de nos manuels S.V.P. vous référez à notre site web: [www.blazeking.com](http://www.blazeking.com)

1. Leaving the unit in place, pull the rear most shroud outward from the fireplace wall by 1/2". (Fig.1)

\*Note: You may remove the front x2 shrouds if more room to work is required.

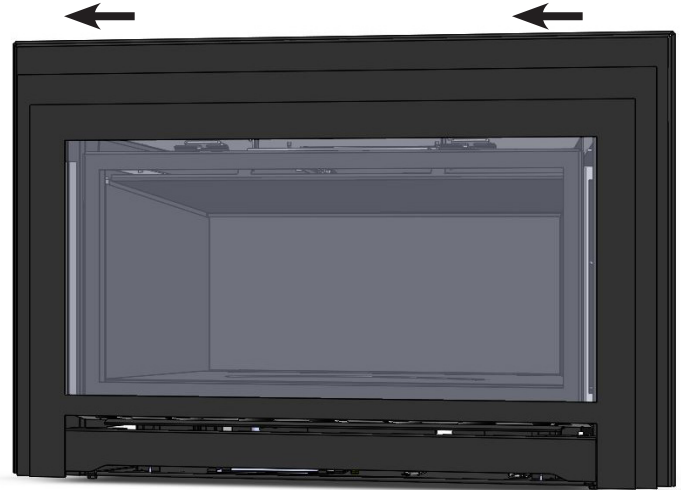

Fig.1

2. With the Mantel Shield centered above the unit, slide it down and behind the rear shroud until its lower edge sits on top of the strongback on the back face of the rear shroud. (Fig. 2)

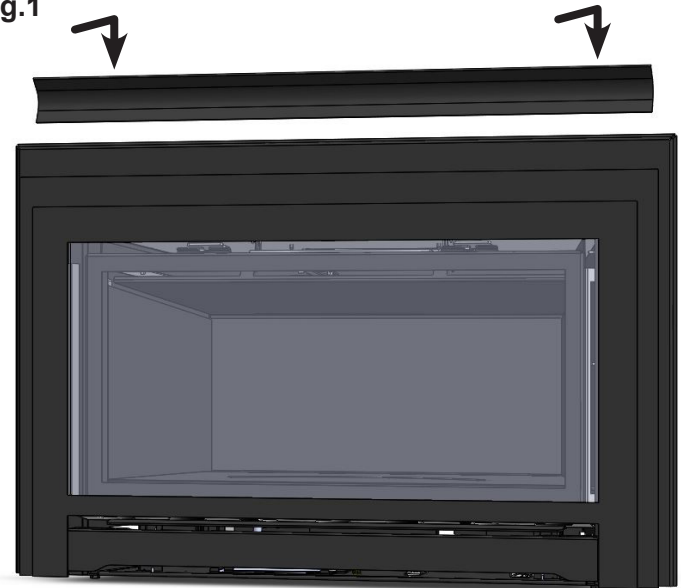

Fig.2

3. Once satisfied with the position of the Mantel Shield, push the rear shroud back against the fireplace wall. (Fig.3)

\*Note: If the front x2 shrouds were removed, reinstall them at this point.

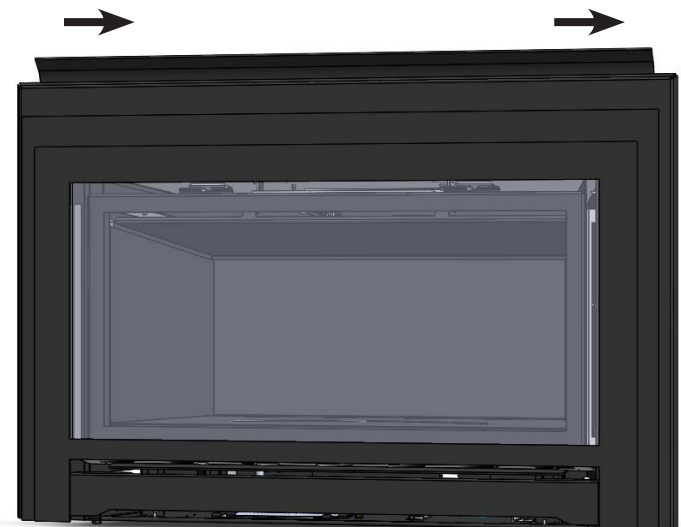

Fig.3

1. Leaving the unit in place, pull the rear most shroud outward from the fireplace wall by 1/2". (Fig.1)

\*Note: You may remove the front x2 shrouds if more room to work is required.

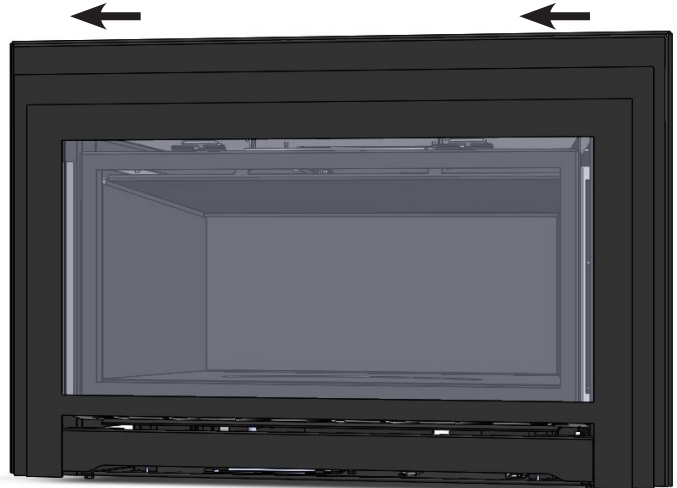

Fig.1

2. With the Mantel Shield centered above the unit, slide it down and behind the rear shroud until its lower edge sits on top of the strongback on the back face of the rear shroud. (Fig. 2)

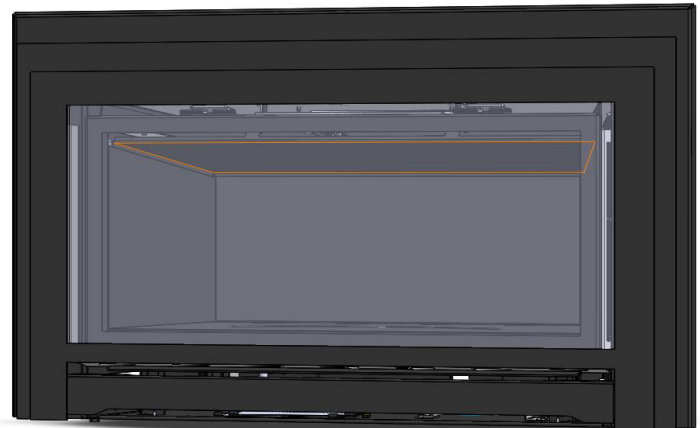

Fig.2

3. Once satisfied with the position of the Mantel Shield, push the rear shroud back against the fireplace wall. (Fig.3)

\*Note: If the front x2 shrouds were removed, reinstall them at this point.

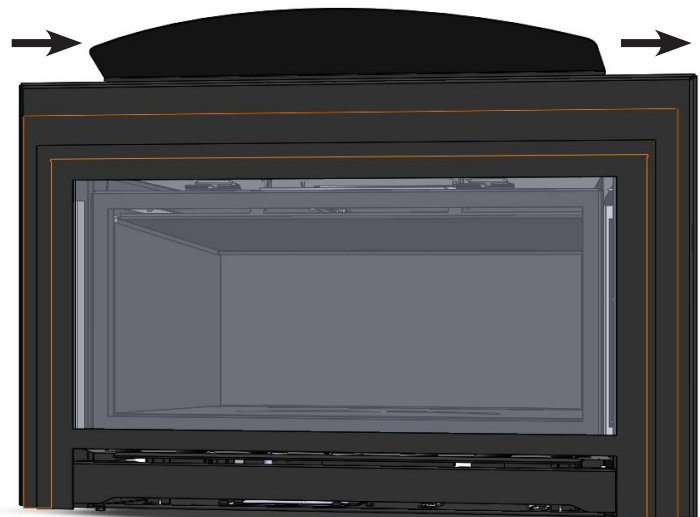

Fig.3