



Z6003FN

CONTEMPORARY FAN KIT

Manufactured By

Valley Comfort Systems Inc.
1290 Commercial Way
Penticton, BC V2A 3H5
CANADA
Phone: 250-493-7444
Fax: 250-493-5833

Blaze King Industries
146 A Street
Walla Walla, WA 99362
U.S.A.
Phone: (509) 522-2730
Fax: (509) 522-9803

#	Step Description
1	REMOVE opening rod bracket from rightside. (2 screws, use #2 robertson)
2	REMOVE outer right side door and hinge. (4 screws, use #2 robertson)

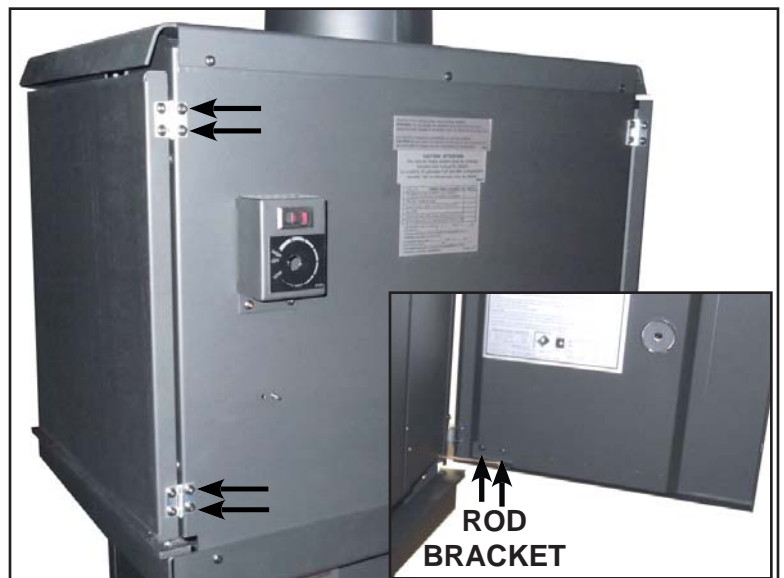

Z6003FN CONTEMPORARY FAN KIT installation

Step Description

- 3** REMOVE fan baffle from stove.
(4 screws, use #2 robertson)

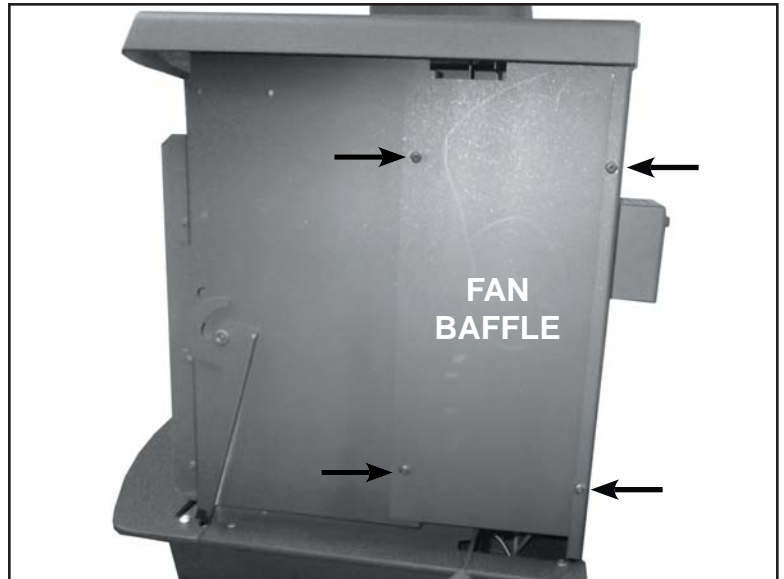

Step Description

- 4** REMOVE pedestal fan mount from stove.
(4 screws, use #2 robertson)



Step Description

- 5** REMOVE screws and nuts from fan.
(4 screws, 4 nuts, use #2 robertson
& 3/8" wrench)

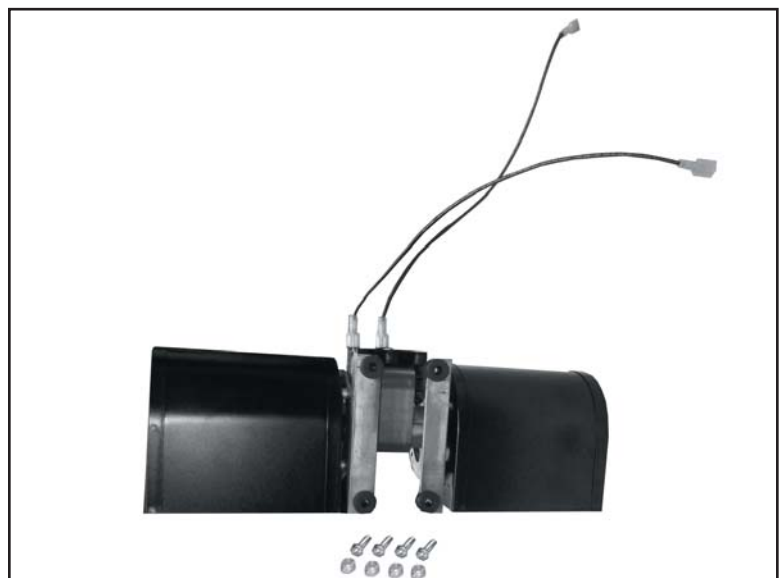

Step Description

6 SCREW fan to pedestal fan mount using hardware from STEP 5. (4 screws, 4 nuts, use #2 robertson & 3/8" wrench)

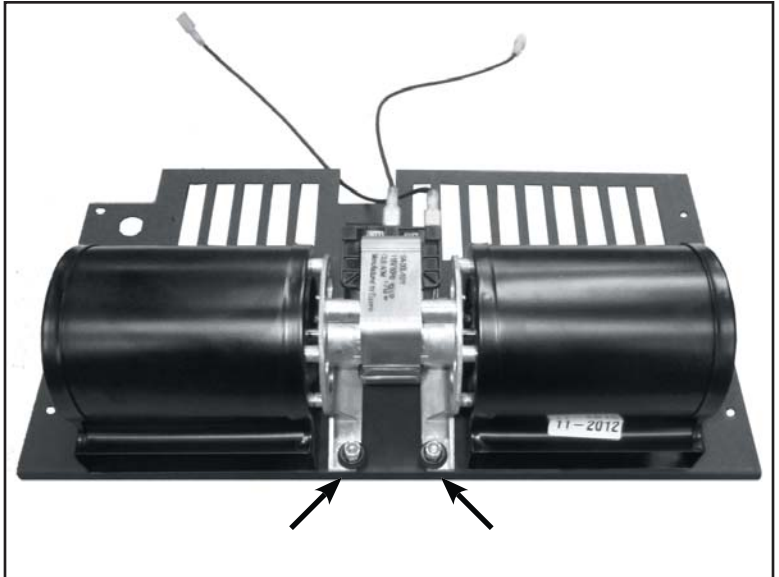

Step Description

7 SLIDE strain relief onto power cord and attach to fan assembly. (use vise grips to squeeze and position strain relief.)

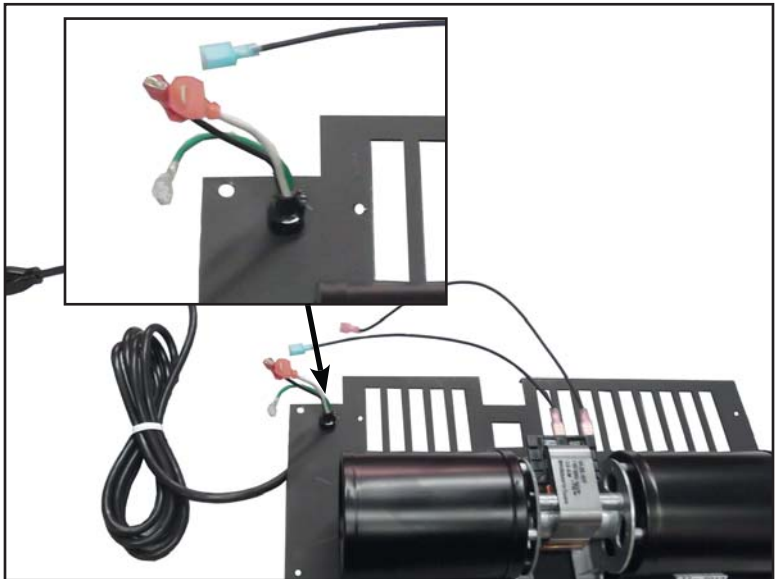

Step Description

8 CONNECT male of power cord to female of fan.

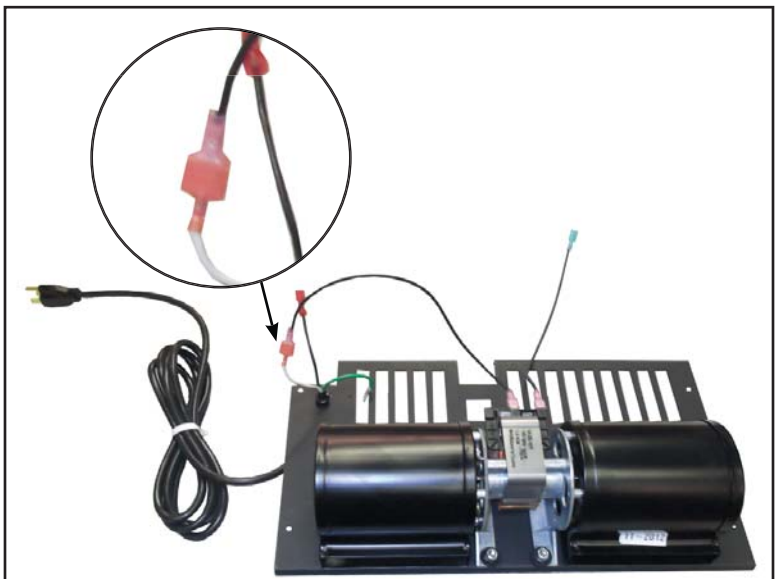

Z6003FN CONTEMPORARY FAN KIT installation**# Step Description**

9 SCREW ground wire to assembly.

**# Step Description**

10 SCREW snap disk assembly to stove. (2 screws, use #2 Robertson)

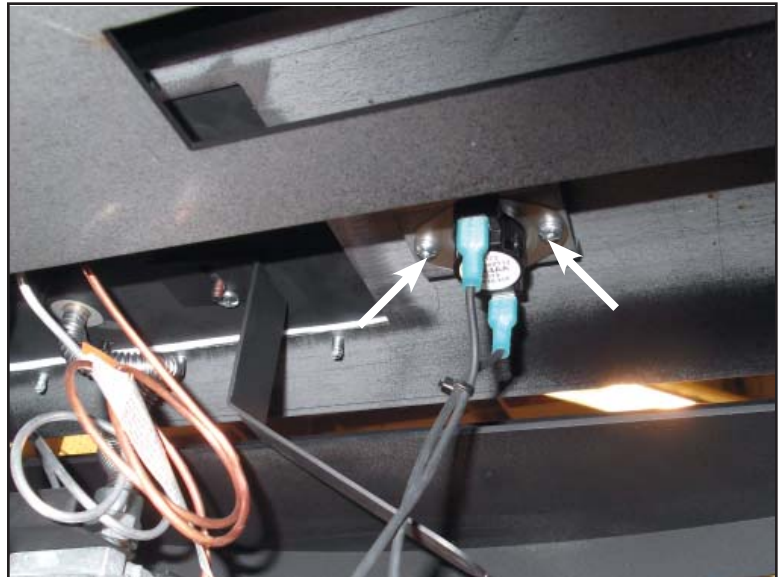
**# Step Description**

11 FEED zip-tied female and male wires from snap disk assembly through grommet. Feed larger male end first.



Step Description

12 SCREW snap disk assembly to stove. (2 screws, use #2 Robertson)



Step Description

13 REMOVE switch box from stove. (2 screws, use #2 robertson)



Step Description

14 INSERT rheostat and connect with 11/16" nut.

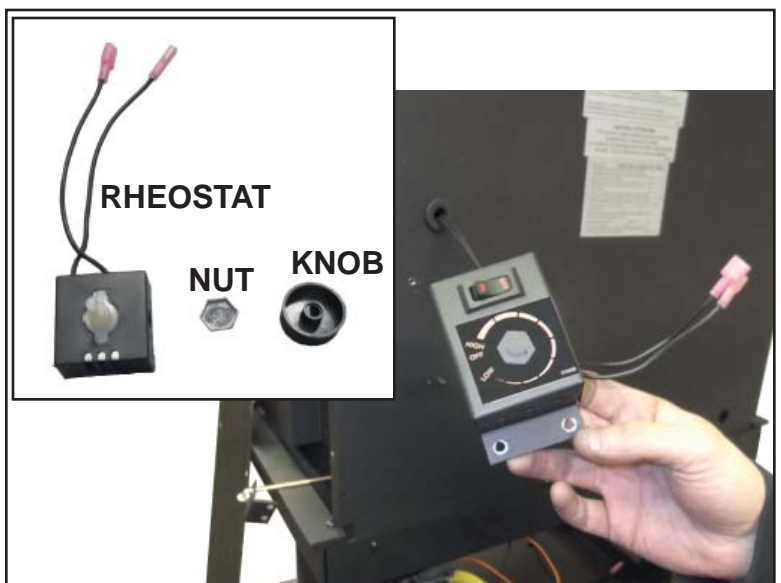

Step Description

15 ATTACH rheostat knob.

**# Step Description**

16 FEED male then female wire through grommet.

**# Step Description**

17 CONNECT male and female ends to snap disk ends

18 COLLECT wires and secure in cable organizer on back.



Step Description

19 SCREW rheostat box back to stove.
(2 screws, use #2 robertson)



Step Description

20 SCREW fan baffle back onto stove.
(4 screws, use #2 robertson)

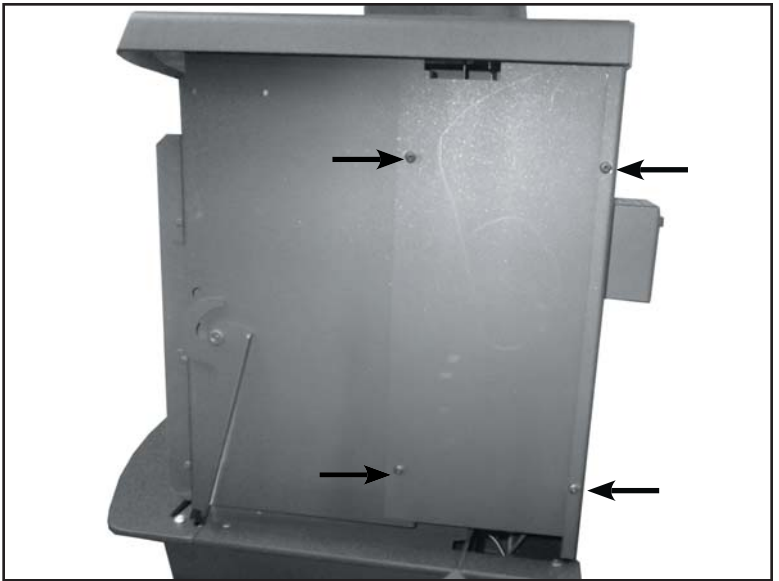

Step Description

21 SCREW outer rightside door and hinges back on. (4 screws, use #2 robertson)

22 SCREW opening rod bracket back onto rightside door. (2 screws, use #2 robertson)

