

Blaze King

S.Z2091 Medium Shroud AF25 29 ^{1/4}"

S.Z2093 Large Shroud AF25 32 ^{1/4}"

NOTE: CAST PARTS SUPPLIED WITH AF25 STOVE



CALIFORNIA PROPOSITION 65

WARNING: This product can expose you to chemicals including benzene, which is known to the State of California to cause cancer and birth defects or other reproductive harm. For more information:

www.P65Warnings.ca.gov

OPERATION & INSTALLATION MANUAL

Manufactured By

Valley Comfort Systems Inc., 1290 Commercial Way, Penticton, BC, V2A 3H5, Canada
Phone: 250-493-7444 - Fax: 250-493-5833 - www.blazeking.com - info@blazeking.com

Pour la version française de nos manuels S.V.P. vous référez à notre site web: www.blazeking.com

S.Z2091 Medium Shroud AF25 29 1/4" or S.Z2093 Large Shroud AF25 32 1/4"

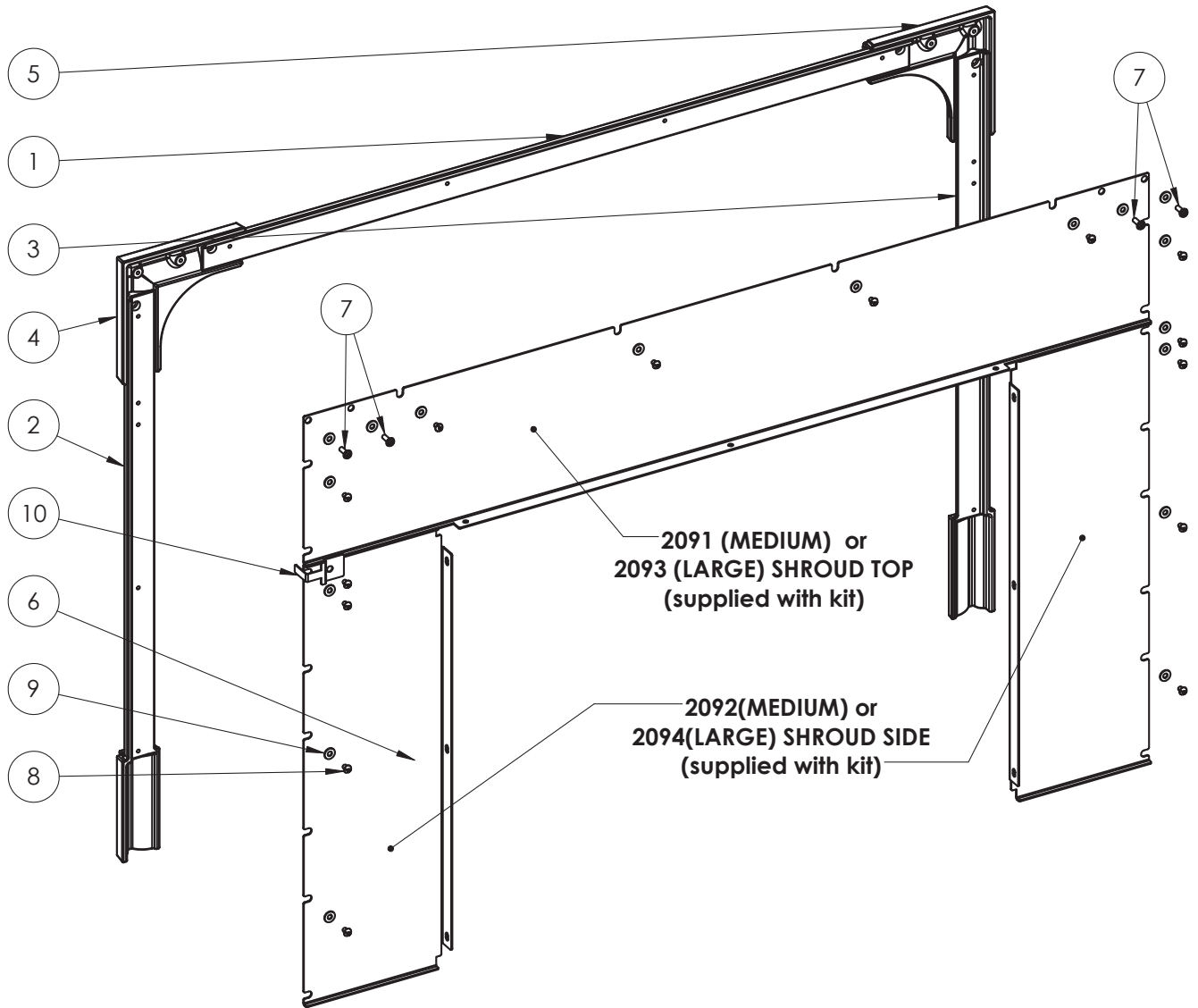

ITEM NO.	PART NUMBER	DESCRIPTION	QTY.
1	110.2016	AF25 CAST SHROUD TRIM TOP	1
2	110.2017	AF25 CAST SHROUD TRIM RIGHT	1
3	110.2018	AF25 CAST SHROUD TRIM LEFT	1
4	110.2021	AF25 CAST TRIM ELBOW RIGHT	1
5	110.2022	AF25 CAST TRIM ELBOW LEFT	1
6	300.0295.A	SCREW TAPPING 10 X 1/2 BLK ZINC	7
7	330.0073	SCREW MACHINE 10-24 X 1/2	4
8	330.0075	SCREW MACHINE 10-24 X 1/4	14
9	375.0009	FLAT WASHER ZP #10	17
10	2099	BYPASS HANDLE HANGER	1

SUPPLIED WITH APPLIANCE

SUPPLIED WITH MANUAL KIT

S.Z2091 Medium Shroud AF25 29 ^{1/4}" or S.Z2093 Large Shroud AF25 32 ^{1/4}"

1. Fasten shroud top panel to stove using three 10x1/2" black screws. (FIG.1)

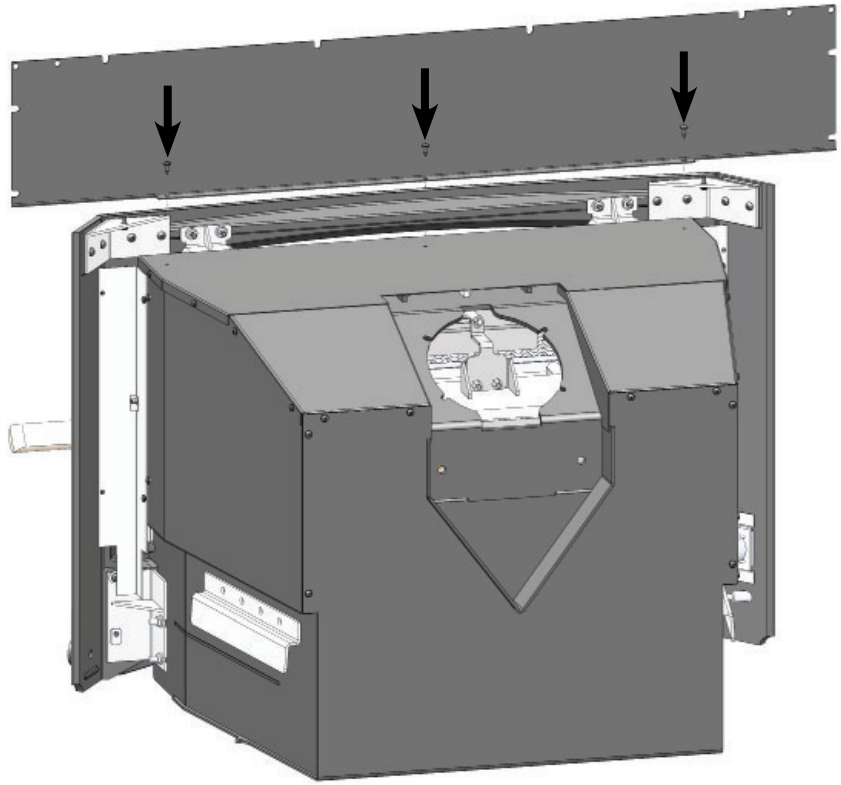

FIG.1

2. Fasten shroud sides to stove using two 10x1/2" black screws per side. (FIG.2)

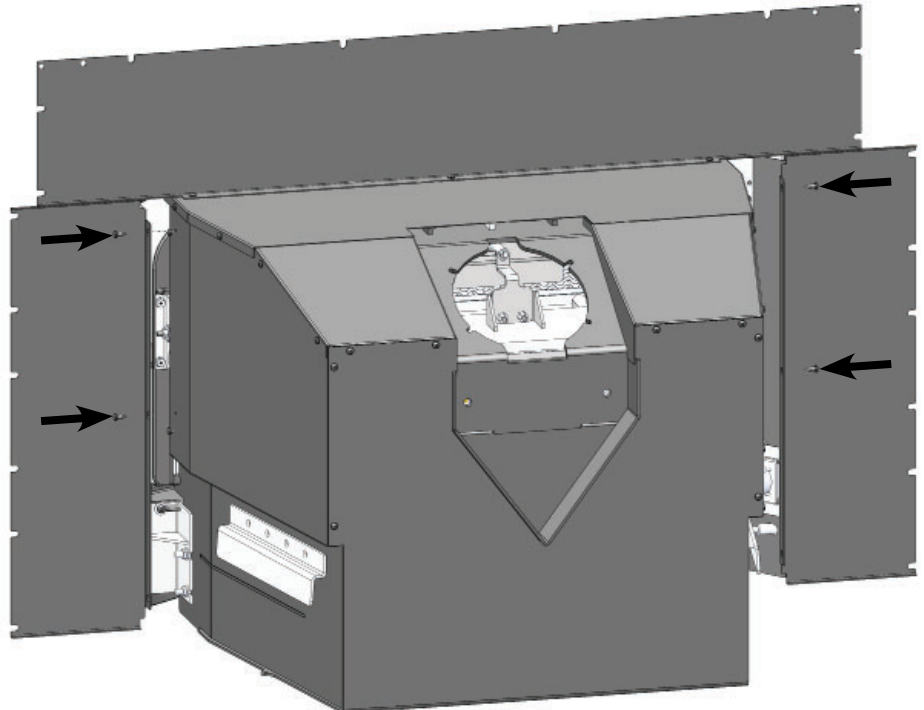

FIG.2

S.Z2091 Medium Shroud AF25 29 1/4" or S.Z2093 Large Shroud AF25 32 1/4"

- Partially thread thirteen 10-24x1/4" machine screws with washers into the top, left, and right cast trim pieces. Leave at least a 1/16" gap between the washers and the cast face. **(FIG.3)** NOTE: Leave one hole open on either the left or right side for the bypass handle hanger bracket.

- Slide the cast trim pieces into their respective positions by aligning the partially fastened screws with the u-shaped cut-outs on the shroud panels. Completely tighten machine screws once the trim is in place.

- Align the left and right cast corners into their respective positions and fasten to the upper shroud panel using four 10-24x1/2" machine screws with washers. **(FIG.4)**

- Attach the bypass handle hanger to the open hole left from **step 3**, use the remaining 10-24x1/4" machine screw to fasten in place. **(FIG.4)**

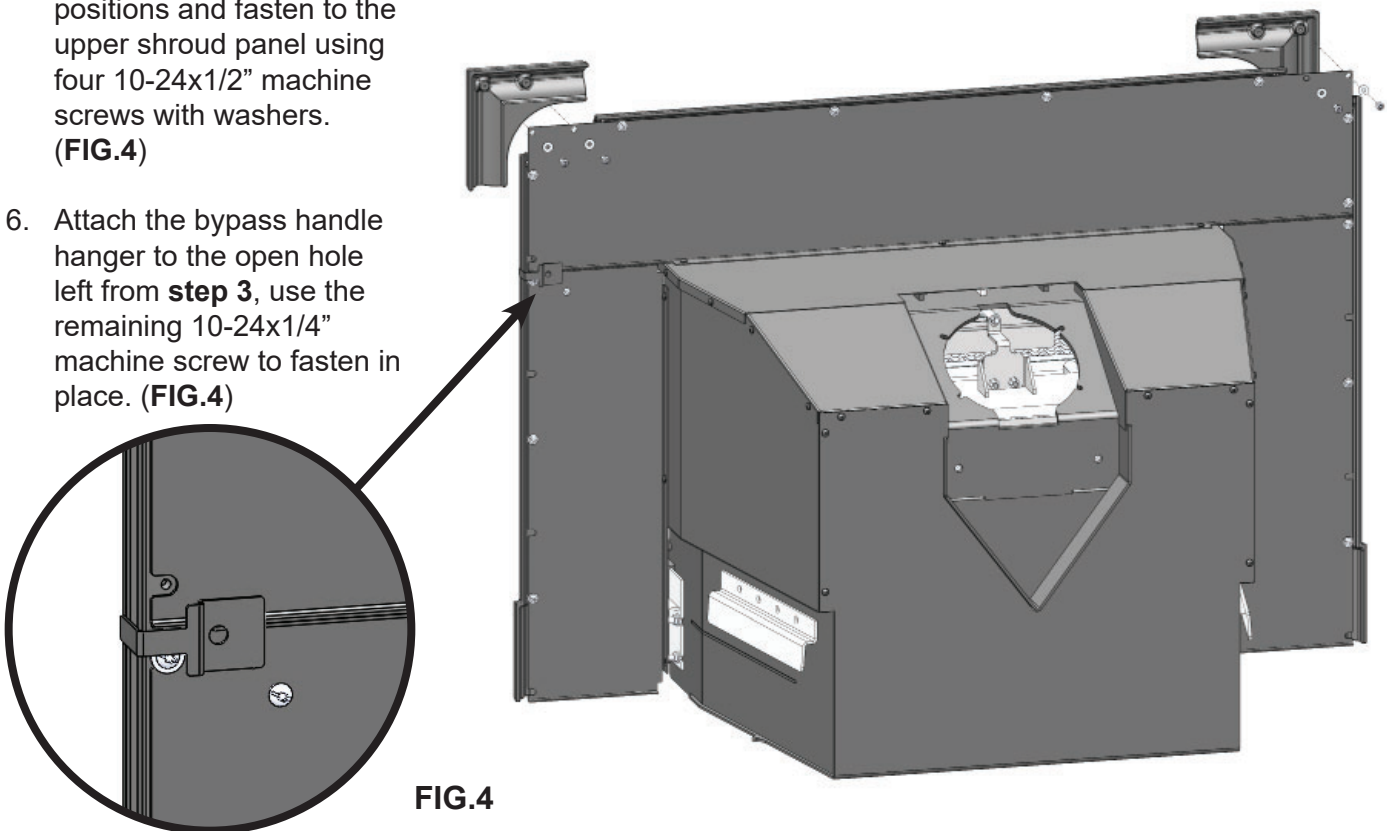
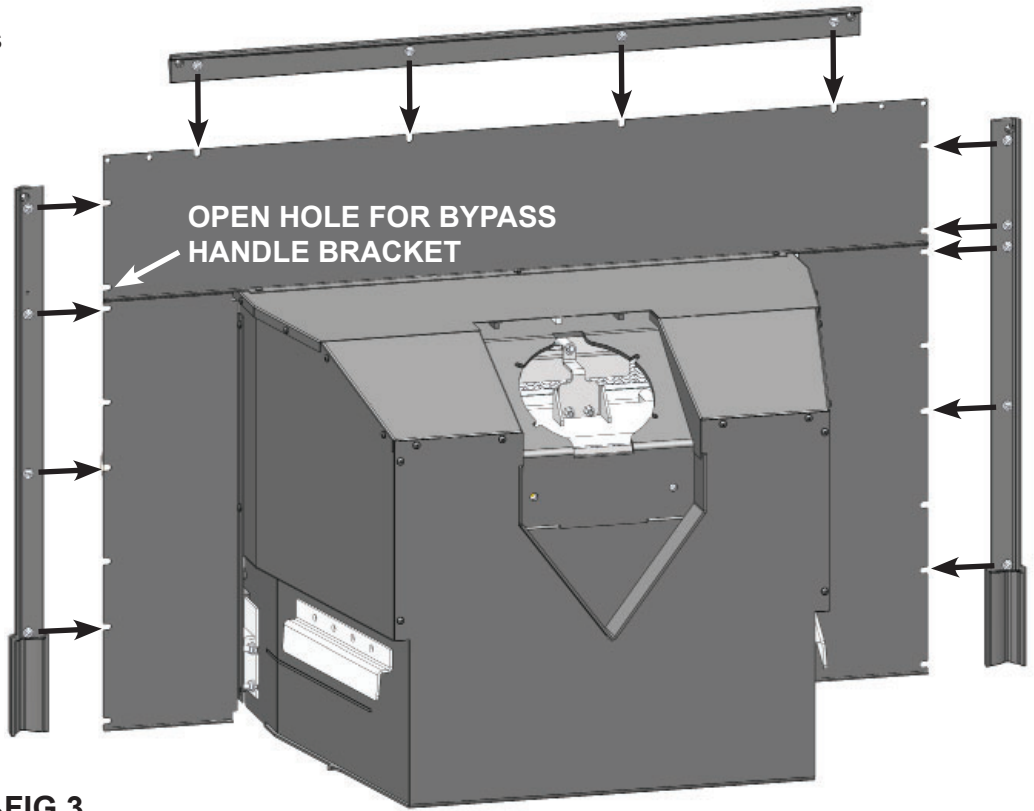

S.Z2091 Medium Shroud AF25 29 1/4" or S.Z2093 Large Shroud AF25 32 1/4"

